

**Planquadrat
Gaiser & Partner
Architects**

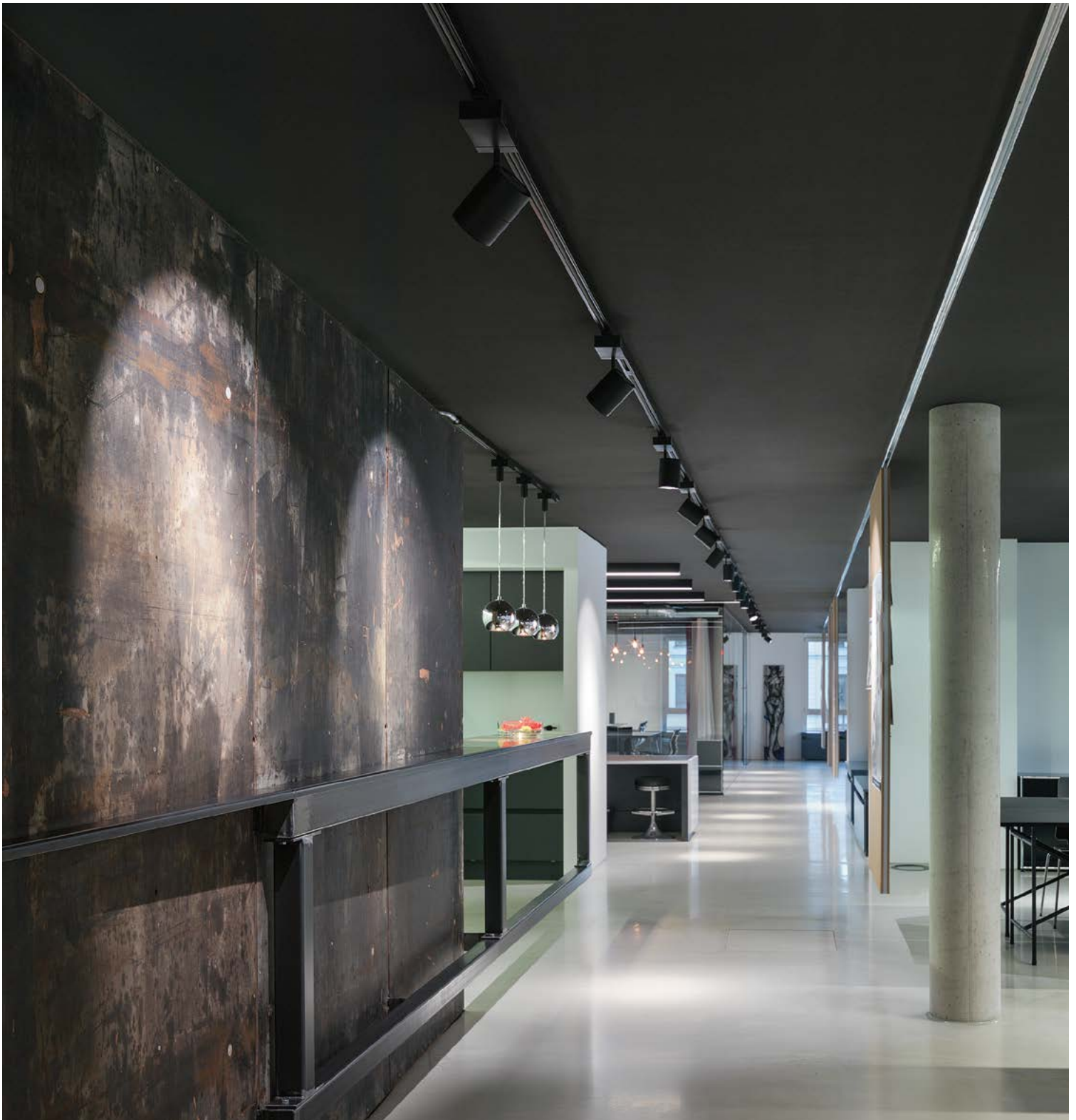

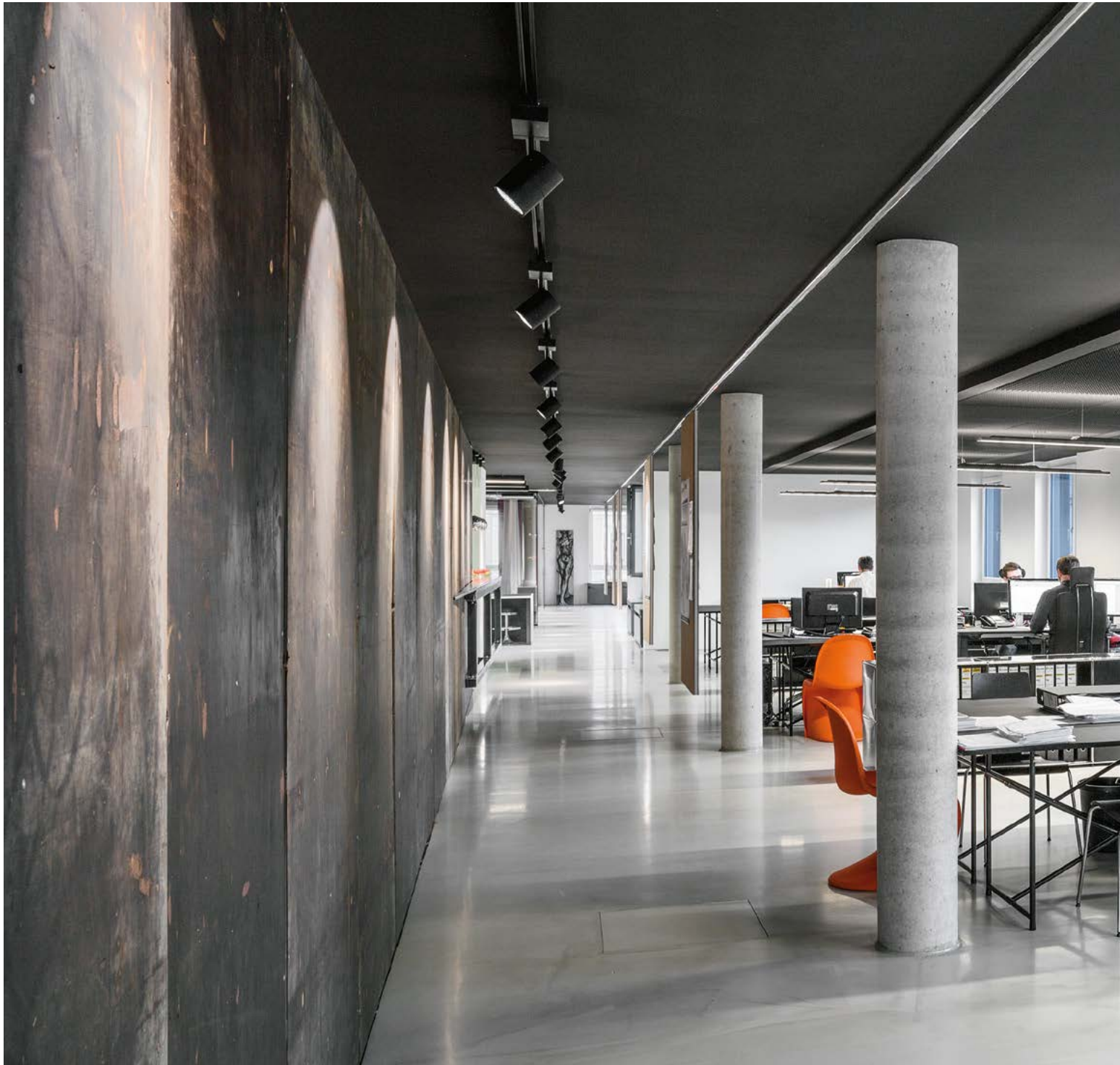

Planquadrat Gaiser & Partner Architekten, Sigmaringen | DE

Construction company: GSW Gesellschaft für Siedlungs- und Wohnungsbau Baden-Württemberg mbH, Sigmaringen | DE

Electrical project design, electrical installation: EZS GmbH & Co. KG, Sigmaringen | DE

Lighting solution: Pendant luminaire SEQUENCE (special paint finish), LED spotlight VIVO M on 3-phase track, strip light SLOTLIGHT II LED (special paint finish), pendant luminaire SCONFINE, LED downlight MICROS, LED module chain TALEXXchain CRYSTAL, continuous run luminaire TECTON, waterproof luminaire CHIARO 2 LED

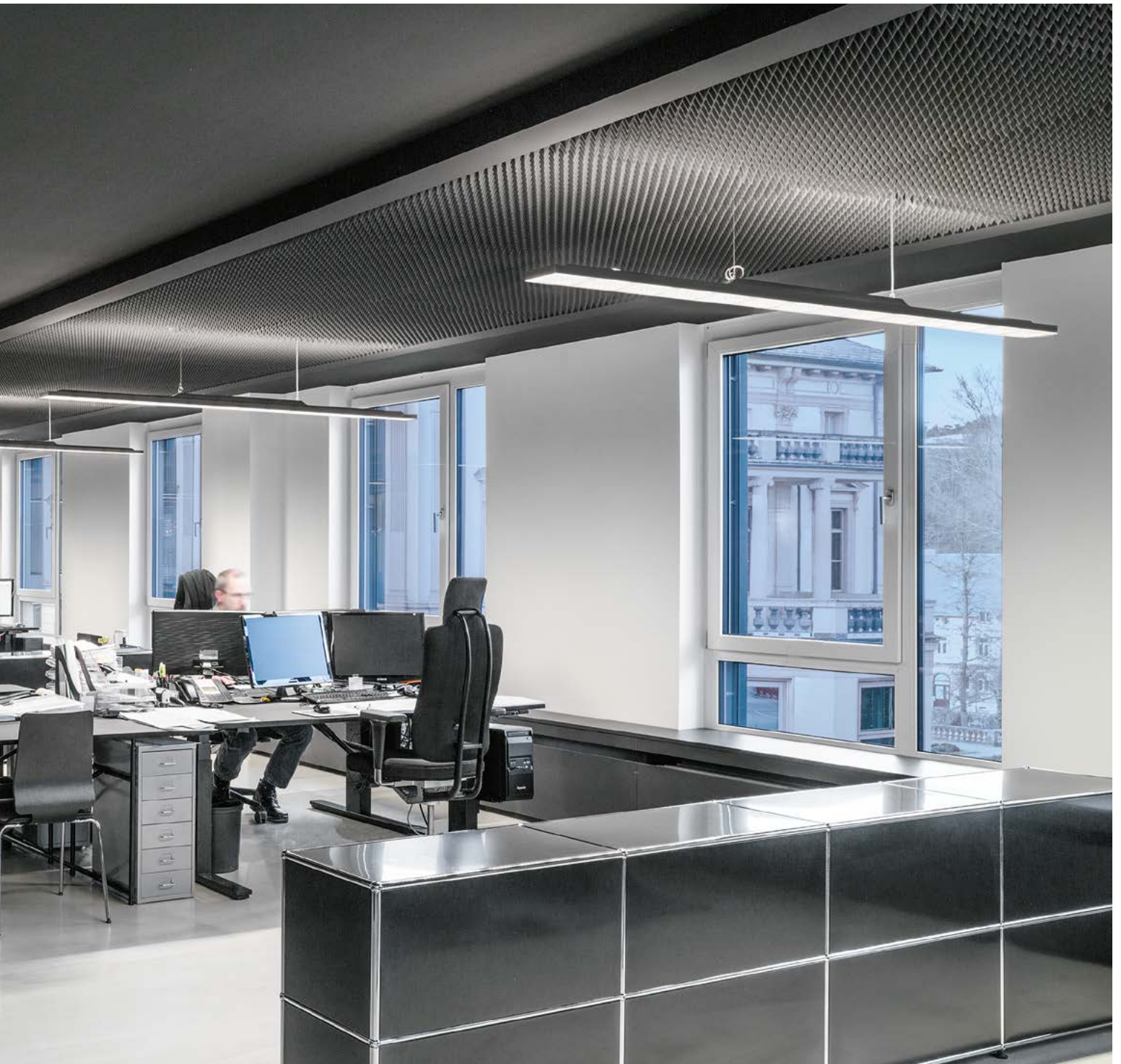

The architect Jürgen Gaiser has created a unique place for creation and communication in a new office building at Leopoldplatz in Sigmaringen. The architectural office was founded eight years ago by four partners; the number of employees has increased to 13 in the meantime. The architecture at the new location in Sigmaringen puts the focus on team spirit by enabling the exchange of ideas in the open space. Black ceilings make the low ceiling heights look taller and remove the room's banality. In accordance with the requirement for a surprising architecture, the lighting solution is more like a stage than a typical office lighting. The latest SEQUENCE LED office luminaires form an inspiring unit with strip lights and spotlights.

Light for offices and communication

The focus is on people in modern office concepts



The consistent black colouring of ceilings and luminaires – partially as standard colour and partially with special paint finish – makes the ceiling invisible in the eyes of the architects. Strong, accentuated light and bright-coloured walls strike the balance.



Increase well-being

A good lighting solution creates viewing conditions where people feel comfortable so that they can concentrate on and are motivated to do their work. Parameters such as even illumination of the workspace, friendly faces and brightened walls and ceilings directly affect the physical and mental condition of the employees.



Create identity

Lighting scenes that can be adapted to personal preferences with variable colour temperature and light level increase the employee satisfaction and create identity. High-quality product design and architectural lighting design also make a valuable contribution here.



Reduce costs

Lighting solutions have direct influence on the operating costs via energy efficiency, durability and light management systems. The status and reputation of a company or building benefit from a resource saving environmental policy.

Light for offices and communication

Innovative lighting concepts are effective

♥ Increase well-being

The open office design, which supports close collaboration in the team and with customers, is appropriately enhanced with a multidimensional lighting solution. Two adjoining work stations in each case form a working island that is brightened in each case with ample daylight and a pendant luminaire. Directly installed above the desks, the modular design SEQUENCE LED luminaire provides both work places with 500 lux on average of glare-free light. The higher light quality and light level as compared with the previous office increase the sense of well-being. Additional linear and point lighting components also make a valuable contribution for this. Architectural light lines are drawn in the entrance and corridor using the SLOTLIGHT II. SCONFINE pendant luminaires invite to linger at the counter.

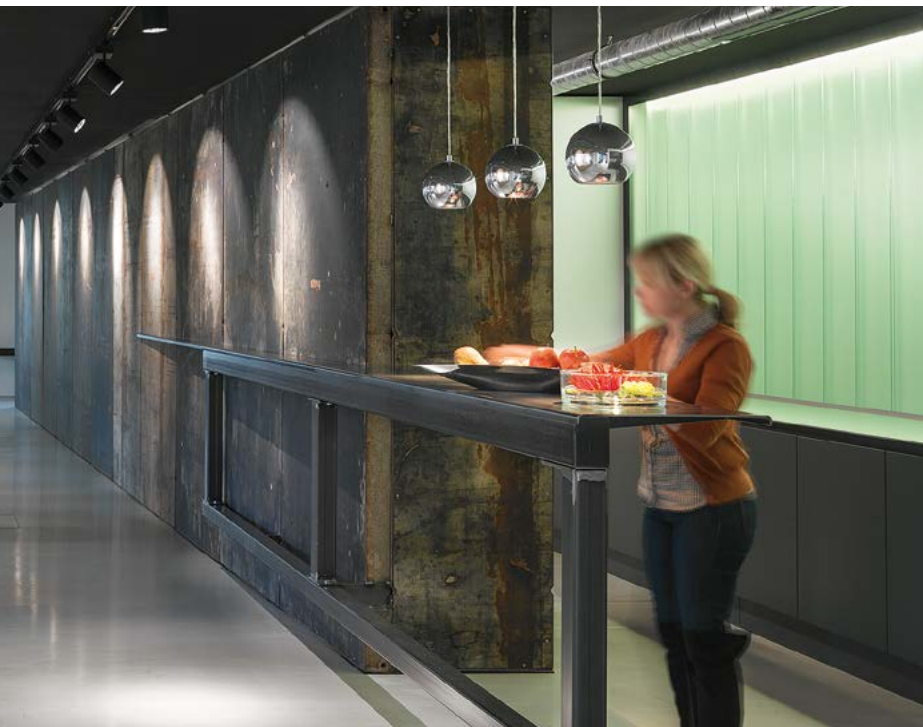

A glass wall illuminated with TECTON and SCONFINE pendant luminaires distinguish the counter as hospitable communication zone.

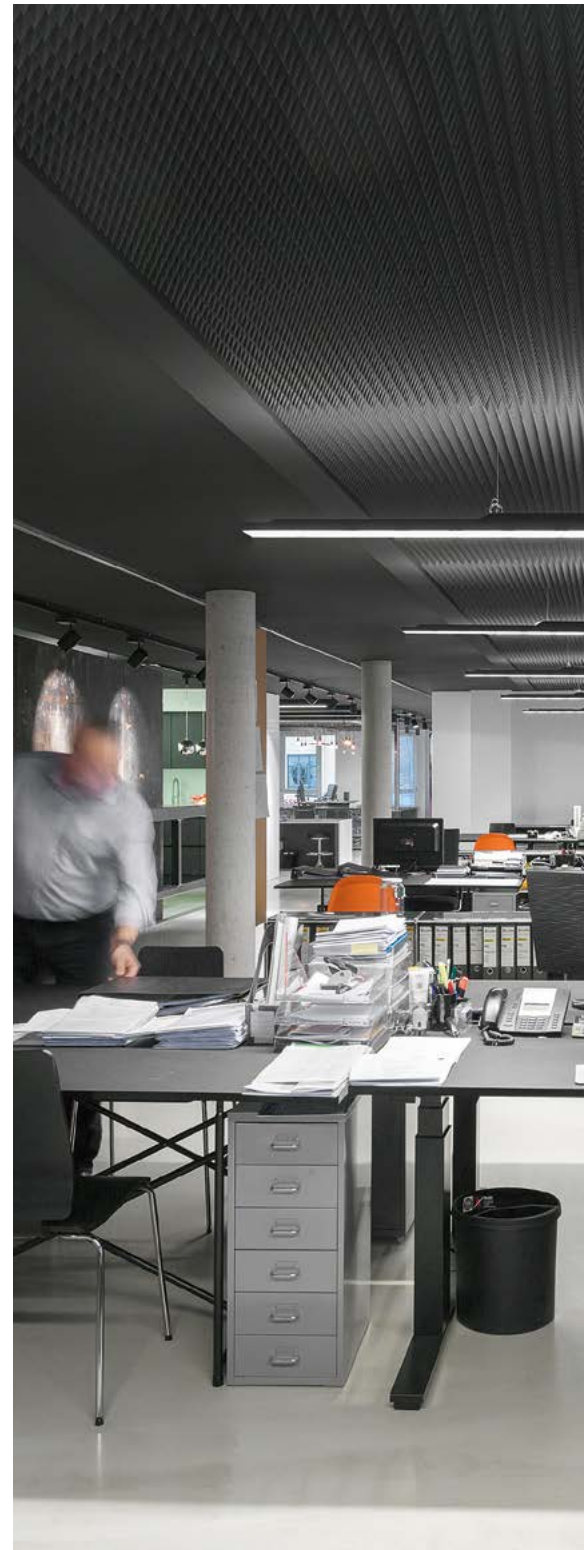

The LED pendant luminaire SEQUENCE colour matched to the black ceiling with high light levels and perfect glare suppression provides the best light in the open-plan office.

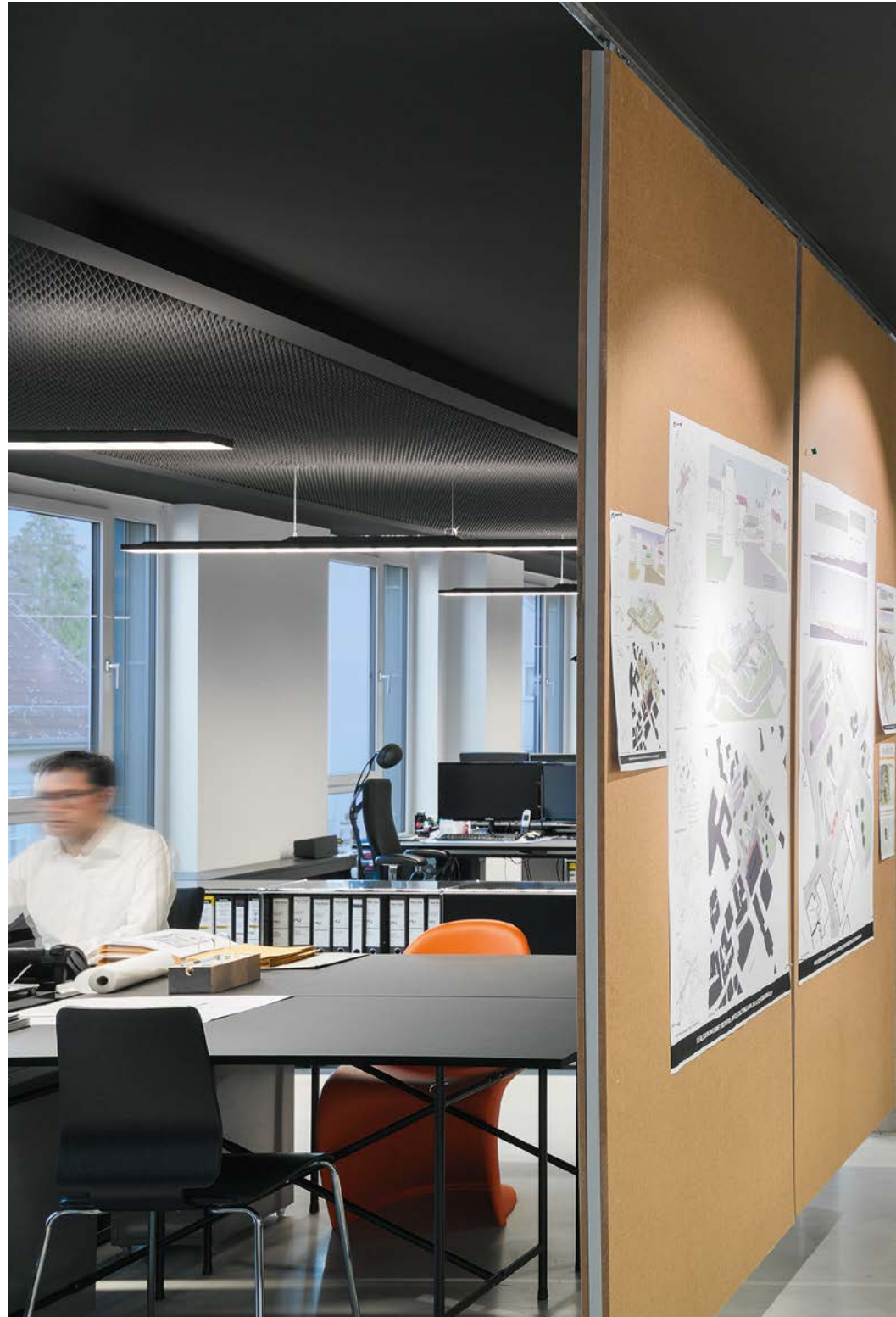

The VIVO LED spotlight puts interesting accents on the walls that – partially movable – are also used as presentation area.



The flush installed SLOTLIGHT strip light in the conference room accommodates the form of the conference table.



Reduce costs

The challenging visual tasks in the architectural office and the long working days of the employees are closely linked with extended operating times of the luminaires. Despite large windows, the lights are switched on all day in the winter months. Nevertheless, it was possible by using energy-efficient LED technology to reduce the electricity costs for the 400 square metres office below the level of a single-family home.



Create identity

The architects and building designers see their basic requirement as creating interesting spaces for customers and employees. Because new ideas could only emerge in an inspiring environment. In its own architectural office, this thinking is expressed, amongst other things, by the use of concrete formwork walls directly from the construction site. Every employee can display his drafts and sketches on the variable room design elements. Accentuated lighting makes the partition walls into sculpture. Like in a gallery, VIVO LED spot lights provide the eye-catching stage. Another guiding principle is to use things as purely and ordered as possible. This can also be clearly seen at the new location in the context with the light. The luminaires are stringently arranged in a line and speak a clear design language.

Courage for unusual solutions



Jürgen Gaiser, architect

Planquadrat Gaiser & Partner Architekten, Sigmaringen | DE

The architectural design of your new architectural office is clearly different from the common office standards. Which objectives and ideas are expressed in the architecture?

Our focus is on team spirit. Not only among the employees, we are also intensively in contact with our clients for up to two years; it is almost like a marriage. Therefore we have decided on open areas. Everybody should know what the others are doing. An open-plan office also includes the thoughts that there is a lot of space available to spread and move physically. We have gained sufficient capacity from the construction of the 400 square metres floor. Every employee has plenty of space and can use the entire shared space that also provides opportunities for privacy. It is certainly unusual to design an office with black ceilings. Nevertheless it seemed to us to be an effective method to hide the low ceiling heights from the eye. This decision has required some courage and we are glad we made it. You never advance if you are always afraid of taking the wrong step.

Is the new environment having an effect on the well-being of the employees and their identification with the company?

The employees are really proud of the new office. They are happy about the pleasant working conditions and have also completely identified themselves with the characteristics of our new company location. One central aspect is the distinctiveness of the solution. We are continuously receiving compliments from customers or colleagues. This also carries over to the employees. High-quality materials are particularly important. Everything you see in our office has first class quality. I prefer to have fewer but high-quality things. This starts with the luminaires in our office, continues via floor covering with concrete optics and ends with table tops with a black linoleum covering. The used concrete formwork walls that we use as partitions are a striking detail. We want to symbolise with this that we change things by building. The construction materials have a life of their own and become sculpture using light.

Your office has existed for eight years. How have the requirements for lighting changed in this time?

We do a very large amount of work for industry, planning office buildings and production facilities with investments between 2 and 10 million euros. There light and its quality and efficiency are a subject that is always present. A lot has been made technically possible in recent years. Now it is a matter of anchoring these possibilities in the minds of customers. Architects and innovative manufacturers like Zumtobel are working together here. It is important to make the added value of light accessible to our customers. Light can do more than only illuminate.

Used concrete formwork walls and CHIARO II waterproof luminares give the character of a construction site to the long service corridor of the architectural office.





ZUMTOBEL

United Kingdom

ZG Lighting (UK) Limited
Chiltern Park
Chiltern Hill, Chalfont St. Peter
Buckinghamshire SL9 9FG
T +44/(0)1388 420 042
lightcentreuk@zumtobelgroup.com
zumtobel.co.uk

USA and Canada

Zumtobel Lighting Inc.
3300 Route 9W
Highland, NY 12528
T +1/(0)845/691 6262
F +1/(0)845/691 6289
zli.us@zumtobel.com
zumtobel.us

Australia and New Zealand

Zumtobel Lighting Pty Ltd
333 Pacific Highway
North Sydney, NSW 2060
T +61/(2)8913 5000
F +61/(2)8913 5001
info@zumtobel.com.au
zumtobel.com.au

China

Zumtobel Lighting China
Shanghai office
Room 101,
No 192 YIHONG Technology Park
Tianlin Road, Xuhui District
Shanghai City, 200233, P.R. China
T +86/(21) 6375 6262
F +86/(21) 6375 6285
sales.cn@zumtobel.com
zumtobel.cn

Hong Kong

Zumtobel Lighting Hong Kong
Unit 4301, Level 43,
Tower 1, Metroplaza,
223 Hing Fong Road,
Kwai Chung, N.T.
T +852/2578 4303
F +852/2887 0247
info.hk@zumtobel.com

India

Zumtobel Lighting GmbH
Vipul Trade Centre, 406, 4th Floor
Sohna Road, Sector 48,
Gurgaon 122002, Haryana, India
T +91/124 4206885 6886
info.in@zumtobel.com

Singapore

Zumtobel Lighting Singapore
158 Kallang Way # 06-01/02
Singapore 349245
T +65 6844 5800
F +65 6745 7707
info.sg@zumtobel.com

United Arab Emirates

Zumtobel Lighting GmbH
4B Street, Al Quoz Industrial Area
Dubai, United Arab Emirates
T +971/4 340 4646
F +971/4 299 3531
info@zumtobel.ae
zumtobel.ae

Romania

Zumtobel Lighting Romania SRL
Radu Greceanu Street, no.2,
Ground Floor, sector 1
012225 Bucharest
T +40 31225 3801
F +40 31225 3804
welcome.ro@zumtobel.com
zumtobel.com

Hungary

ZG Lighting Hungary Kft.
Váci út 49
1134 Budapest
T +36/(1) 450 2490
F +36/(1) 350 0829
welcome@zumtobel.hu
zumtobel.hu

Croatia

ZG Lighting d.o.o.
Radnička cesta 80
10000 Zagreb
T +385/(1) 64 04 080
F +385/(1) 64 04 090
welcome@zumtobel.hr

Bosnia and Herzegovina

ZG Lighting d.o.o.
Predstavništvo u BiH
Zmaja od Bosne 7
71000 Sarajevo
T +387 33 590 463
welcome.ba@zumtobel.com

Serbia

ZG Lighting d.o.o.
Beton hala – Karađordeva 2-4
11000 Belgrade
M+381 69 54 44 802
welcome@zumtobel.rs

Czech Republic

ZG Lighting Czech Republic s.r.o.
Jankovcova 2
Praha 7
170 00 Praha
T +420 266 782 200
F +420 266 782 201
welcome@zumtobel.cz
zumtobel.cz

Slovak Republic

ZG Lighting Slovakia s.r.o.
Tomášikova 64
831 04 Bratislava
welcome@zumtobel.sk
zumtobel.sk

Poland

ZG Lighting Polska Sp. z o.o.
Wołoska 9a
Platinum Business Park III
02-583 Warszawa
T +48 22 856 74 31
zgpolska@zumtobelgroup.com
zumtobel.pl

Slovenia

ZG Lighting d.o.o
Štukljeva cesta 46
1000 Ljubljana
T +386/(1) 5609 820
F +386/(1) 5609 866
si.welcome@zumtobelgroup.com
zumtobel.si

Russia

Zumtobel Lighting GmbH
Official Representative Office
Skakovaya Str. 17
Bld. No 1, Office 1104
125040 Moscow
T +7/(495) 945 36 33
F +7/(495) 945 16 94
info-russia@zumtobel.com
zumtobel.ru

Norway

Zumtobel Belysning
Strømsveien 344
1081 Oslo
T +47 22 82 07 00
info.no@zumtobel.com
zumtobel.no

Sweden

Zumtobel Belysning
Birger Jarlsgatan 57
11356 Stockholm
T +46 8 26 26 50
info.se@zumtobel.com
zumtobel.se

Denmark

Zumtobel Belysning
Stamholmen 155, 5. sal
2650 Hvidovre
T +45 35 43 70 00
info.dk@zumtobel.com
zumtobel.dk

Headquarters

Zumtobel Lighting GmbH
Schweizer Strasse 30
Postfach 72
6851 Dornbirn, AUSTRIA
T +43/(0)572/390-0
info@zumtobel.info

ZG Licht Mitte-Ost GmbH
Grevenmarschstrasse 74-78
32657 Lemgo, GERMANY
T +49/(0)5261 212-0
F +49/(0)5261 212-9000
info@zumtobel.de

zumtobel.com

5

JAHRE GARANTIE

Top quality – with a five-year guarantee.

As a globally leading luminaire manufacturer, Zumtobel provides a five year manufacturer's guarantee on all Zumtobel branded products in accordance with the terms of guarantee at zumtobel.com/guarantee.

09/15-EN © Zumtobel Lighting GmbH

Technical data was correct at time of going to press.

We reserve the right to make technical changes without notice. Please contact your local sales office for further information.